

PRODUCT SPECIFICATION

CERTA-COM® TRENCHLESS CONDUIT

Certa-Lok® Restrained Joint Integral Bell

Certa-Com® PVC pipe features Certa-Lok®, the industry original non-metallic mechanically restrained joint system designed for use in electrical utilities, data, and optical fiber communication conduit systems. Certa-Com electrical conduit is manufactured with outside diameters (IPS sized) and wall thickness of Sch 40 pipe and meets all performance requirements of NEMA TC-2, and is certified to UL 651 and CSA C22.2 No. 211.2.

Certa-Lok pipe provides a restrained joint by utilizing precision-machined grooves on the conduit and in integral bell which, when aligned, allow a spline to be inserted, resulting in a fully circumferential restrained joint that locks the pipes together. A flexible elastomeric gasket in the integral bell provides a hydraulic seal.

APPLICATIONS

- Electrical utilities
- Data and optical fiber communications
- Rigid PVC (non-metallic) conduit

INSTALLATION METHODS

- Horizontal Directional Drilling (HDD)
- Open/continuous Trench

FEATURES & BENEFITS

- Easy and fast assembly and disassembly if needed
- Widely accepted and specified
- Immediate full strength joint (no solvent or fusion required)
- Segmented pipe minimizes job-site footprint and related traffic disruptions
- Lowers overall costs, improves safety
- Excellent for navigating around obstacles, environmentally sensitive areas
- Minimize weather related damage by using HDD Conduit
- Superior crush and stiffness over HDPE
- Fits standard rigid nonmetallic conduit fittings

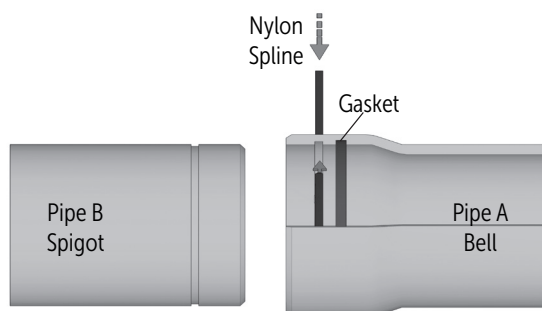

SHORT FORM SPECIFICATION

Conduit Standard:	NEMA TC-2, UL 651*, CSA C22.2 No. 211.2*	
Diameter Std.:	Iron Pipe Size (IPS)	
Nominal Sizes:	3", 4", 5", 6"	Schedule 40
	8"	Schedule 80
Seal Pressure Ratings:	80 psi	
Max. Wire Rating:	90°C	
Length:	20'	
Wall Thickness:	Schedule 40	
Color	Gray	
Conduit Compound:	ASTM D1784 Cell Class 12454	
Conduit Joint Std.:	UL 651*	
Max. Angular Joint Deflection:†	0.5°	
Gasket Material Offering:	NBR	
Certifications:	UL 651*, CSA C22.2 No. 211.2*	

*See Installation Guide for more information.

*3"-6" Sch 40 only.



PRODUCT SPECIFICATION

CERTA-COM® TRENCHLESS CONDUIT

Certa-Lok® Restrained Joint Integral Bell

CERTA-COM PIPE DIMENSIONS

Nom. Size	Outside Diameter (OD)	Class	Pipe							
			Min. Wall Thickness (T1)	Min. Internal Diameter (ID)	X	W	D	P	BOD	Weight (lb/ft)
3"	3.500	Sch 40	0.216	3.008	3.000	0.500	0.095	0.241	3.980	1.5
4"	4.500	Sch 40	0.237	3.961	3.000	0.500	0.095	0.241	5.020	2.1
5"	5.563	Sch 40	0.258	4.975	3.000	0.500	0.095	0.241	6.100	2.8
6"	6.625	Sch 40	0.280	5.986	3.000	0.500	0.095	0.241	7.240	3.6
8"	8.625	Sch 80	0.500	7.455	3.163	0.500	0.190	0.241	9.660	8.3

Notes:

1. These dimensions are for estimating purposes only. All dimensions are in inches unless otherwise specified.
2. Maximum Pull Force based on UL witness testing in accordance with Sections 21 and 22 of UL 651. An appropriate safety factor must be applied during pullback. Use instrumentation to ensure that this target pulling load is not exceeded.
3. Straight Max. Pull Force value shown is effective end load at failure developed as a result of pressure and/or pulling.
4. Minimum internal diameter per UL 651 and NEMA TC-2.

PERFORMANCE DATA

Nom. Size	SDR	Seal Pressure Rating (psi)	Min. Bend Radius (ft)	Max. Pull Force (lbf)		Max. % Change per 20' Stick
				Straight	At Min. Bend Radius	
3"	Sch 40	80	65	10,200	9,000	15.40
4"	Sch 40	80	65	12,700	9,500	15.40
5"	Sch 40	80	65	13,900	10,000	15.40
6"	Sch 40	80	65	16,700	12,000	15.40
8"	Sch 80	80	72	30,000	25,000	14.00

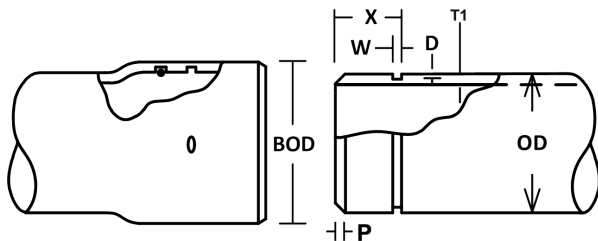

CERTA-COM ACCESSORIES

Application	Nom. Size	Splines					Gaskets			
		Material	Size	Color	Length	Part Number	Material	Shape	Size	Part Number
Standard	3"	Nylon	0.170x0.350	Grey	12"	S0312TN0	NBR	Round	0.138	OR030CCON
	4"	Nylon		Grey	15"	S0415TN0	NBR	Round	0.210	OR040YMNN
	5"	Nylon		Grey	18.5"	S0518TN0	NBR	Round	0.210	OR050IBON
	6"	Nylon		Grey	22"	S0622TN0	EPDM	Round	0.210	OR060IBOE
	8"	Nylon	0.313x0.313	Red	32"	S0832SN1	NBR	Round	0.375	OR080YMNI

Some or all of these products are protected by patents. Visit www.westlakepipe.com/patents for more information.