

PRODUCT SPECIFICATION

CERTA-COM® TRENCHLESS CONDUIT

Certa-Lok® Restrained Joint Integral Bell

Certa-Com PVC pipe features Certa-Lok, the industry original non-metallic mechanically restrained joint system designed for use in electrical and communication conduit systems. Certa-Com PVC pipe is made in iron pipe size (IPS) outside diameters and meets all performance requirements of NEMA TC-2 and UL 651.

Certa-Lok pipe provides a restrained joint by utilizing precision-machined grooves on the conduit and in integral bell which, when aligned, allow a spline to be inserted, resulting in a fully circumferential restrained joint that locks the pipes together. A flexible elastomeric gasket in the integral bell provides a hydraulic seal.

APPLICATIONS

- Telecommunications duct
- Power and communications duct
- Rigid PVC (non-metallic) conduit

INSTALLATION METHODS

- Horizontal Directional Drilling (HDD)
- Open/continuous Trench

FEATURES & BENEFITS

- Easy and fast assembly
- Widely accepted and specified
- Immediate full strength joint (no solvent or fusion required)
- Segmented pipe minimizes job-site footprint and related traffic disruptions
- Lowers overall costs, improves safety

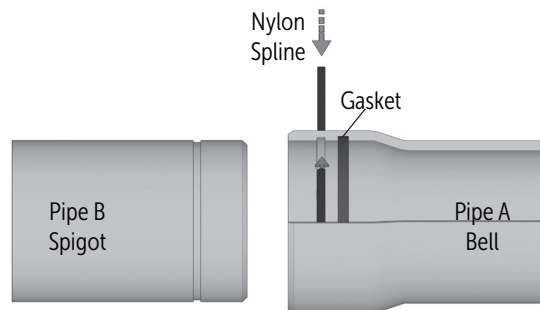

SHORT FORM SPECIFICATION

Conduit Standard:	NEMA TC-2, UL 651*
Diameter Std.:	Iron Pipe Size (IPS)
Nominal Sizes:	3", 4", 5", 6", 8"
Seal Pressure Ratings:	80 psi
Max. Wire Rating:	90°C
Length:	20'
Color	Gray
Conduit Compound:	ASTM D1784 Cell Class 12454
Conduit Joint Std.:	UL 651*
Max. Angular Joint Deflection:‡	0.5°
Gasket Material Offering:	NBR
Certifications:	ASTM D2321

‡See Installation Guide for more information.

* 3"-6" Sch 40 only.



PRODUCT SPECIFICATION

CERTA-COM® TRENCHLESS CONDUIT

Certa-Lok® Restrained Joint Integral Bell

CERTA-COM PIPE DIMENSIONS

Nom. Size	Outside Diameter (OD)	Class	Pipe							
			Min. Wall Thickness (T1)	Min. Internal Diameter (ID)	X	W	D	P	BOD	Weight (lb/ft)
3"	3.500	Sch 40	0.216	3.008	3.000	0.500	0.095	0.241	3.980	1.5
4"	4.500	Sch 40	0.237	3.961	3.000	0.500	0.095	0.241	5.020	2.1
5"	5.563	Sch 40	0.258	4.975	3.000	0.500	0.095	0.241	6.100	2.8
6"	6.625	Sch 40	0.280	5.986	3.000	0.500	0.095	0.241	7.240	3.6
8"	8.625	Sch 80	0.500	7.455	3.163	0.500	0.190	0.241	9.660	8.3

Notes:

1. These dimensions are for estimating purposes only. All dimensions are in inches unless otherwise specified.
2. Maximum Pull Force based on UL witness testing in accordance with Sections 21 and 22 of UL 651. An appropriate safety factor must be applied during pullback. Use instrumentation to ensure that this target pulling load is not exceeded.
3. Straight Max. Pull Force value shown is effective end load at failure developed as a result of pressure and/or pulling.
4. Minimum internal diameter per UL 651 and NEMA TC-2.

PERFORMANCE DATA

Nom. Size	SDR	Seal Pressure Rating (psi)	Min. Bend Radius (ft)	Max. Pull Force (lbf)		Max. % Change per 20' Stick
				Straight	At Min. Bend Radius	
3"	Sch 40	80	65	10,200	9,000	15.40
4"	Sch 40	80	65	12,700	9,500	15.40
5"	Sch 40	80	65	13,900	10,000	15.40
6"	Sch 40	80	65	16,700	12,000	15.40
8"	Sch 80	80	72	30,000	25,000	14.00

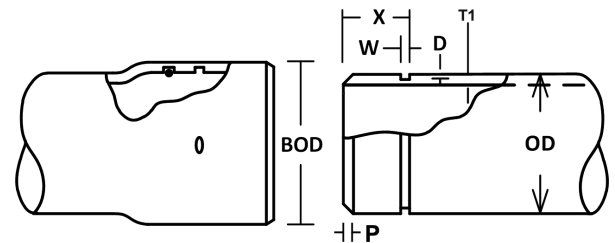

Some or all of these products are protected by patents. Visit www.westlakepipe.com/patents for more information.

CERTA-COM ACCESSORIES

Application	Nom. Size	Splines				Gaskets			
		Material	Size	Length	Part Number	Material	Shape	Size	Part Number
Standard	3"	Nylon	0.170x0.350	12	S0312TN0	NBR	Round	0.138	OR030CCON
	4"	Nylon	0.170x0.350	15	S0415TN0	NBR	Round	0.210	OR040YMNN
	5"	Nylon	0.170x0.350	18.5	S0518TN0	NBR	Round	0.210	OR050IBON
	6"	Nylon	0.170x0.350	22	S0622TN0	NBR	Round	0.210	OR060IBON
	8"	Nylon	0.313x0.313	32	S0832SN1	NBR	Round	0.375	OR080YMNI