

SIGNED DRAWINGS MUST ACCOMPANY PURCHASE ORDER OR DIMENSIONS OF FITTINGS WILL NOT BE GUARANTEED

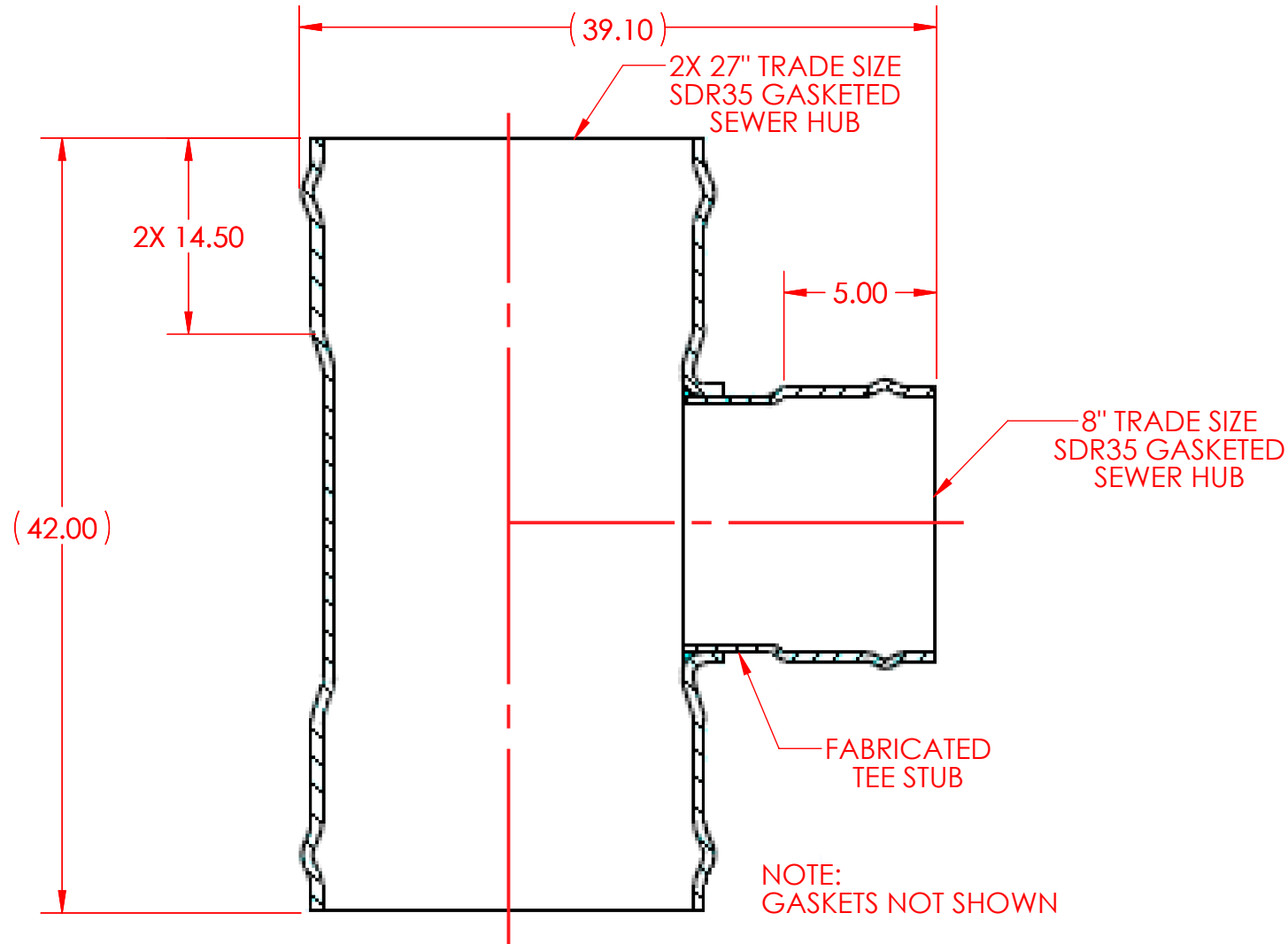

DISCLAIMER - PLEASE READ

--DIMENSIONS AND APPEARANCE ARE APPROXIMATE AND SUBJECT TO CHANGE WITHOUT NOTICE DUE TO DESIGN OR PRODUCTION MODIFICATIONS
--ANGLE TOLERANCE IS +/- 2 DEGREES.
--ALL OTHER DIMENSIONS ARE TO TOLERANCES OF +/- 1"
--ALL FITTINGS ARE SUBJECT TO RBP "STANDARD TERMS AND CONDITIONS"

REF.
07A272708GGG
07Q---GGG-SPEC

NAPCO PIPE & FITTINGS

56400 Mound Road
Shelby Township, MI 48316
U.S.A.
Phone (800) 232-5690 | Fax (586) 781-0888
CSshelby@napcopipe.com | www.napcopipe.com

27" STRAIGHT TEE with 8" BRANCH
PVC SDR35 GASKETED SEWER
27"x 27"x 8" GxGxG

PRINTED COPIES ARE FOR REFERENCE ONLY

DATE: 6/8/2021 DRAWN BY: GEB
DATE: 6/8/2021 CHECKED BY: RSS

L1027-8.L