

SIGNED DRAWINGS MUST ACCOMPANY PURCHASE ORDER OR DIMENSIONS OF FITTINGS WILL NOT BE GUARANTEED

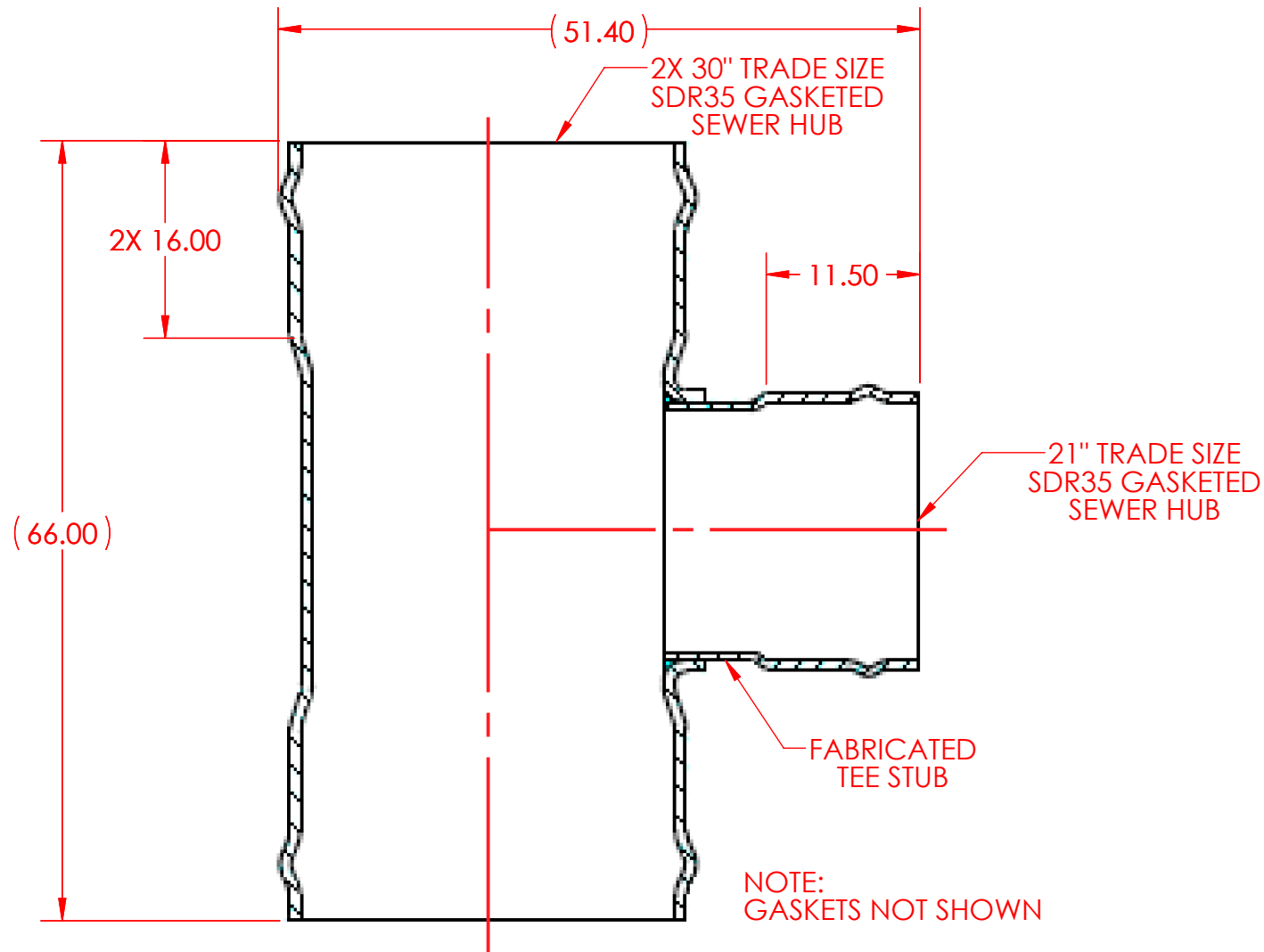

**DISCLAIMER - PLEASE READ**

--DIMENSIONS AND APPEARANCE ARE APPROXIMATE AND SUBJECT TO CHANGE WITHOUT NOTICE DUE TO DESIGN OR PRODUCTION MODIFICATIONS  
--ANGLE TOLERANCE IS +/- 2 DEGREES.  
--ALL OTHER DIMENSIONS ARE TO TOLERANCES OF +/- 1"  
--ALL FITTINGS ARE SUBJECT TO RBP "STANDARD TERMS AND CONDITIONS"

REF.  
07A303021GGG  
07Q---GGG-SPEC

**NAPCO** PIPE & FITTINGS

56400 Mound Road  
Shelby Township, MI 48316  
U.S.A.  
Phone (800) 232-5690 | Fax (586) 781-0888  
CSshelby@napcopipe.com | www.napcopipe.com

**30" STRAIGHT TEE with 21" BRANCH**  
**PVC SDR35 GASKETED SEWER**  
**30"x 30"x 21" GxGxG**

PRINTED COPIES ARE FOR REFERENCE ONLY

DATE: 3/22/2022 DRAWN BY: GEB  
DATE: 3/22/2022 CHECKED BY: RSS

L1030-21.L